

CDPD1H, CDPD2H Pressure Switch

Dialmatic Diaphragm Pressure Difference

CDPD1H, CDPD2H, VCDPD1H, VCDPD2H Series

- ✦ Extremely Versatile
- ✦ Factory Pre-set or Field Adjustable
- ✦ Easy Setpoint Adjustment
- ✦ Pressure Differential

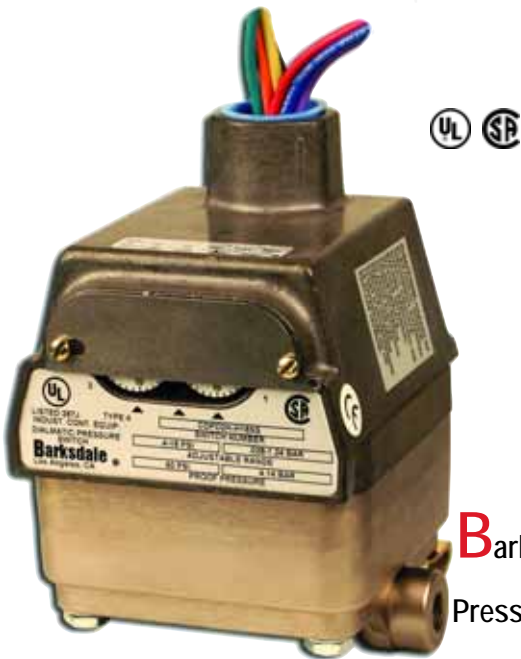

Barksdale's CDPD1H and CDPD2H Housed Diaphragm Differential Pressure Switches are the answer for pressure control applications requiring tamper proof external adjustment and environments which require water-tight NEMA 4 housings. These pressure switches are available in single or dual control settings for both positive pressure and vacuum models, to 150 psi. The switches may be wired normally open or normally closed through a 3/4"-14 NPT conduit connection to free leads. All models feature calibrated dials for adjusting setpoints in units can be factory set upon request. For applications requiring a highly reliable, accurate switch in a durable package, Barksdale's CDPD1H and CDPD2H Housed Diaphragm Differential Pressure Switches are the ideal choice.

CDPD1H, CDPD2H Pressure Switch

With Barksdale - Pressure's No Problem

As recognized leader in the manufacture of pressure product solutions, Barksdale pressure switches meet the demanding needs of our customers. From 29" Hg to 18,000 psi, Barksdale has pressure switches for a variety of applications – from transformers to natural gas compressors to beverage dispensers – and more!

Barksdale's Diaphragm Pressure Switches provide an economical solution for your pressure sensing needs. Diaphragm switches accurately control pressures from 30 inches of mercury vacuum to 150 psi positive pressure, and can be factory pre-set upon request. Setpoint adjustment is easily accomplished by turning the adjustment screws, which are protected by a tamper-resistant cover on housed models. A variety of available factory options allows the diaphragm switches to be configured to the exact needs of your application.

Diaphragm Pressure Switch Applications

With its economical design and high repeatability, **Barksdale's Diaphragm Pressure Switches** provide an accurate and reliable solution for pressures up to 150 psi, making them ideal for use in:

- Pump & Compressor Monitoring
- Air Proving in HVAC Systems
- Engine Monitoring
- Machine Tools
- Hydraulic Power Units

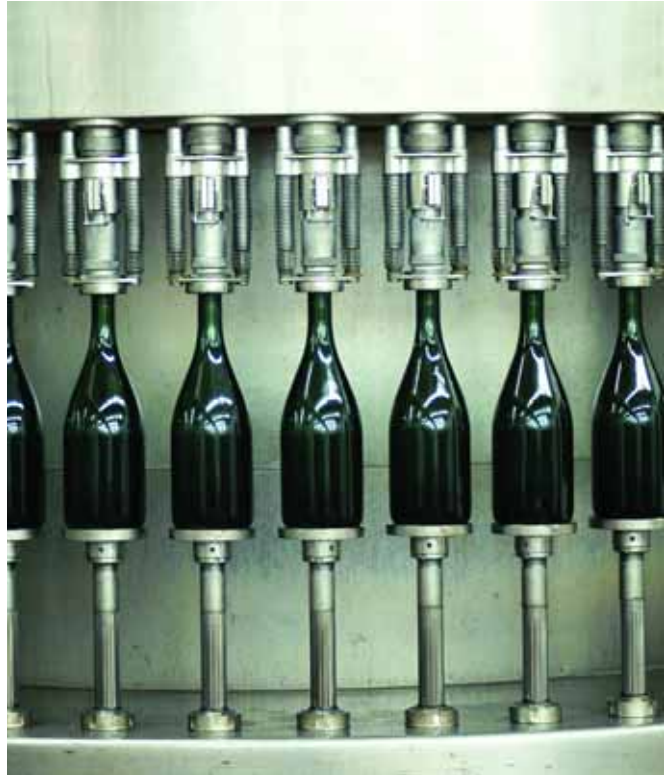

Need Something Special?

If you have special product requirements, we can help. Barksdale specializes in custom design solutions to meet your needs. Our reputation is built on creating custom products for customers committed to getting exactly what they need. We have design engineers and technical specialists who are experts in solving your unique pressure problems. Our technology and resources are at your disposal.

Need More Information?

Call us. We are only a phone call away.
Toll-Free: 1-800-835-1060.

CDPD1H, CDPD2H Pressure Switch

General Description

Electrical Characteristics All models incorporate Underwriters' Laboratories, Inc. listed single pole double throw snap-action switching elements. Switches may be wired "normally open" or "normally closed".

Performance Characteristics

Switch SPDT single or dual circuit
Electrical Rating 10 Amps @ 125/250 VAC; 3 Amps @ 480 VAC; 0.5 Amp @ 24 VDC (Class A or H limit switch)

Physical

Weight Single & Dual - Approximate 3.50 lbs.,
Enclosure/Housing Housed Water Tight Housing (NEMA 4) Tamper-proof External Adjustment.
Electrical Connection Free leads approximately 18" long No. 16 AWG standard AWN 105/c wire (U.L. Approved) through 1/2" conduit connection 1/4" NPT internal thread.
Pressure Connection
Wetted Materials
Diaphragm 17-7 PH stainless steel

Approvals/Listings

UL UL listed; File # E42816
CSA CSA listed under guide 380-W-1.16, Class 3231, File # 22355

Environmental

Temperature Range -65° to +165°F

WIRE CODE				
Lead	Circuit #1		Circuit #2	
	Pressure	Vacuum	Pressure	Vacuum
Normally Closed	Blue	Red	Orange	Yellow
Common	Purple	Purple	Brown	Brown
Normally Open	Red	Blue	Yellow	Orange

Adjustment Instructions

Pressure Turn adjustment screw clockwise to lower actuation point (switch setting).
Vacuum Turn adjustment screw counterclockwise to approach atmospheric pressure.

Consult Factory for these Options

NEMA 4X
 Cleaned for Oxygen Service

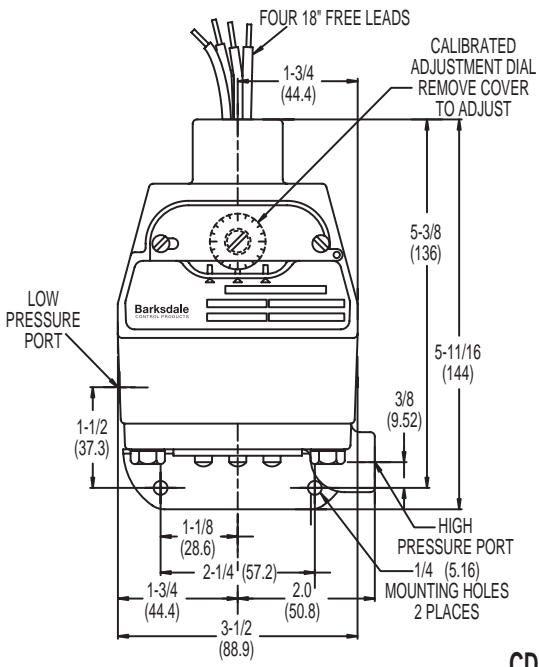

CDPD1H

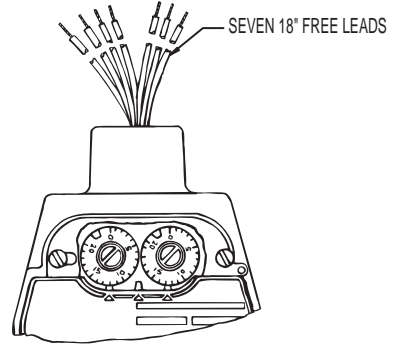
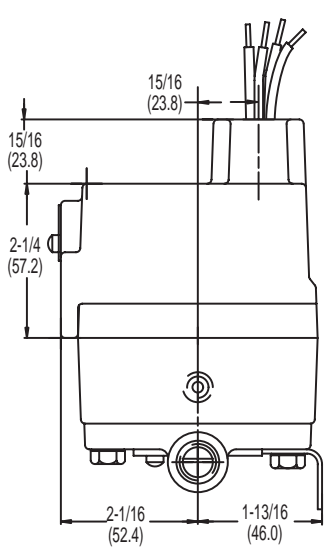

CDPD2H

CDPD1H, CDPD2H Pressure Switch

Dialmatic Diaphragm Pressure Difference

CDPD1H, CDPD2H, VCDPD1H, VCDPD2H Series

H Hermetically sealed limit switch (optional); Class 1 Division 2. Requires class AA, CC, or HH limit switch.

Basic Configuration
 CDPD1H Single setpoint housed
 CDPD2H Dual setpoint housed
 VCDPD1H Single setpoint housed - Vacuum
 VCDPD2H Dual setpoint housed - Vacuum

Limit Switch

- A 10 Amps @ 125/250 VAC; 3 Amps @ 480 VAC; .5 Amp @ 24 VDC (standard for 3SS, 80SS, and 150SS ranges)
- B 10 Amps @ 125/250/480 VAC; 2 Amps @ 600 VAC; 15 Amps @ 12 VDC (consult sales drawing for deadband values)
- H 10 Amps @ 125/250 VAC; 3 Amps @ 480 VAC; .5 Amp @ 24 VDC (standard for 2SS and 18SS ranges)
- M 10 Amps @ 125/250 VAC; 3 Amps @ 480 VAC; 15 Amps @ 12 VDC; 2 Amps @ 24 VDC (consult sales drawing for deadband values)
- GH 1 Amp @ 125 VAC; 1 Amp @ 24 VDC Gold Contact (consult sales drawing for deadband values)
- AA Hermetically sealed; 4 Amps @ 125/250 VAC (consult sales drawing for deadband values)
- CC Hermetically sealed; 10 Amps @ 125/250 VAC (consult sales drawing for deadband values)
- HH Hermetically sealed; 5 Amps @ 125/250 VAC (consult sales drawing for deadband values)

Adjustable Range

PRESSURE SWITCHES

	Adjustable Range				Approx. Deadband (Actuation Value)	Proof Pressure
	Decreasing - psi (bar)		Increasing - psi (bar)			
	Min	Max	Min	Max	psi-(bar)	psi (bar)
3SS	.03 (0)	2.76 (.2)	.27 (.02)	3 (.2)	.09 - .24 (0 - .02)	10 (.7)
18SS	.4 (.03)	17.68 (1.2)	.72 (.05)	18 (1.2)	.18 - .32 (.01 - .02)	60 (4.1)
80SS	.5 (.03)	75.3 (5.2)	5.2 (.4)	80 (5.4)	2.2 - 4.7 (.2 - .3)	160 (10.9)
150SS	1.5 (.1)	141.3 (9.7)	10.2 (.7)	150 (10.2)	3.5 - 8.7 (.2 - .6)	300 (20.4)

VACUUM SWITCHES

	Adjustable Range				Approx. Deadband (Actuation Value)	Proof Pressure
	Decreasing - In. Hg		Increasing - In. Hg			
	Min	Max	Min	Max	In. Hg	In. Hg
3SS	0.06	5.72	0.34	6	.14 - .28	6
18SS	0.8	29.2	1.6	30	.4 - .8	30

Options

-FX NEMA 4X Enclosure
 -WXXX Extra wire length (XXX = inches)

CDPD1H -A 18SS

Example: CDPD1H-A18SS

Miscellaneous:	
Paper Tag	\$5.00
Metal Tag:	\$10.00

Barksdale
CONTROL PRODUCTS

3211 Fruitland Avenue • Los Angeles, CA 90058 • ☎ 800-835-1060 • Fax: 323-589-3463 • www.barksdale.com